

IEC appliance inlet C20, screw-on mounting, front side, solder/quick connect terminal



Screw-On Version

C20



70° C

**Description**

- Panel Mount:
Screw-on from front side
- Inlet, Pin temperature 70 °C, Protection class I
- Solder terminals or quick connect terminals

Approvals

- VDE License Number: 40020659
- UL License Number: E96454
- CSA License Number: 56242

Weblinks

[Approvals](#), [RoHS](#), [CHINA-RoHS](#), [e-Store](#), [SCHURTER-Stock-Check](#), [Distributor-Stock-Check](#)

Technical Data

| | | | |
|---------------------------|--|-------------------------|---|
| Ratings IEC | 16 A / 250 VAC; 50 Hz | Appliance-Inlet/-Outlet | C20 acc. to IEC/EN 60320-1, UL 498, CSA C22.2 no. 42 (for cold conditions) pin-temperature 70 °C, 16A, Protection class I |
| Ratings UL/CSA | 20 A / 250 VAC; 60 Hz | | |
| Dielectric Strength | > 2.2 kVAC between L-N > 4 kVAC between L/N-PE (1 min/50 Hz) | | |
| Allowable Operation Temp. | -25 °C to 70 °C | | |
| Degree of Protection | from front side IP 40 acc. to IEC 60529 | | |
| Protection Class | Suitable for appliances with protection class I acc. to IEC 61140 | | |
| Terminal | Solder terminals or quick connect terminals | | |
| Panel Thickness s | Screw-on: max 8 mm Mounting screw torque max 0.5 Nm | | |
| Material: Housing | Thermoplastic, black, UL 94V-0 | | |

Dimensions

4798

Length |—————| 53 mm

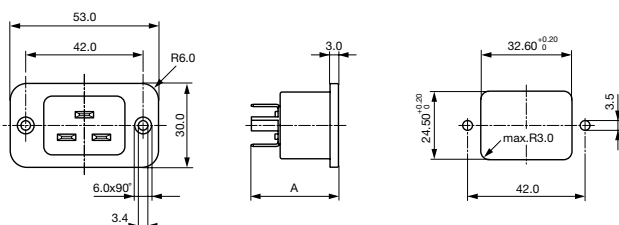

A = 31.5 mm: quick-connect terminals 6.3 x 0.8 mm

A = 30 mm: quick-connect terminals 4.8 x 0.8 mm

A = 28.5 mm: solder terminals

Distributor-Stock-Check | SCHURTER-Stock-Check | e-Store

Variants

Distributor-Stock-Check | SCHURTER-Stock-Check | e-Store

| Panel mounting | Panel Thickness s [mm] | Terminal | Order Number |
|----------------|---------------------------|--------------------------------------|--------------|
| Screw-on | - | Quick connect terminals 4.8 x 0.8 mm | 4798.9100 |
| Screw-on | - | Quick connect terminals 6.3 x 0.8 mm | 4798.9000 |
| Screw-on | - | Solder terminals | 4798.9200 |

Packaging unit 100 Pcs

Accessory

Description



Assorted Covers
Rear Cover

0859.0047



Cord retaining kits
Cord retaining strain relieve

Countersunk, K

4700.0010